

OPERATING MANUAL & PARTS LIST

12303A, 12403A, 12601A & 12801A

E
N
G
L
I
S
H

PALMGREN

Purchase
Sept 26 - 12

3", 4", 6" & 8"

LOW PROFILE DRILL PRESS VISE

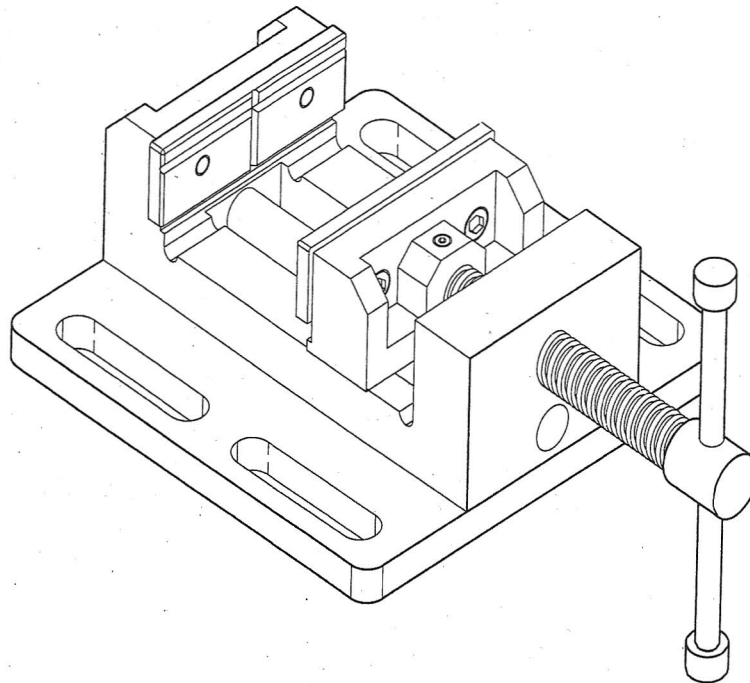

E
S
P
A
Ñ
O
L

Read carefully and follow all safety rules and operating instructions before first use of this product.

28633.00 - 0908

DESCRIPTION

Palmgren 3", 4", 6" and 8" Low-Profile Drill Press Vises are made of durable cast iron and steel. Vises are provided with four mounting slots for securing vise to work surface.

SAFETY RULES

- Understand and obey all safety instructions supplied with drill press, mill or other machines on which vise is used.
- Bolt or clamp vise to work surface in at least two mounting locations using mounting flanges provided on base.

DIMENSIONS

Refer to Figure 1.

Stock No.		12303	12403	12601	12801
Jaw Width	A	3"	4"	6"	8"
Throat Depth	B	1 $\frac{1}{16}$ "	1 $\frac{1}{4}$ "	2"	2"
Jaw Opening	C	3"	4"	6"	8"
Overall Height	H	2 $\frac{1}{16}$ "	2 $\frac{1}{8}$ "	3 $\frac{1}{16}$ "	3 $\frac{1}{16}$ "
Base Length	L	6 $\frac{1}{2}$ "	7 $\frac{1}{8}$ "	10 $\frac{1}{16}$ "	15 $\frac{1}{16}$ "
Base Width	W	5 $\frac{1}{16}$ "	6 $\frac{1}{8}$ "	9 $\frac{1}{8}$ "	11 $\frac{1}{16}$ "

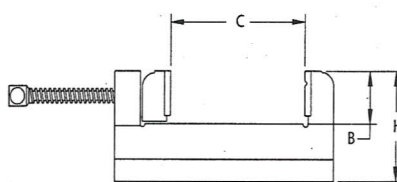
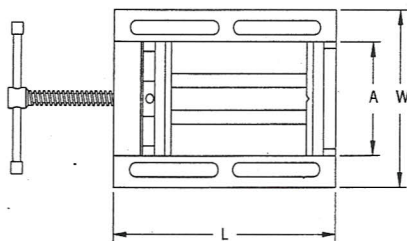

Figure 1 - Dimensions

OPERATION

Refer to Figure 2.

- Mount vise to work surface in desired location by securing at least two mounting flanges located on base (Ref. No. 1).
- Open jaws of vise and place workpiece between jaws in desired position. Secure workpiece between jaws by rotating leadscrew with handle (Ref. No. 3). Be sure workpiece is held securely in vise before starting machining operation.

MAINTENANCE

Particles of metal or wood can damage machined surfaces, causing difficult or inaccurate operation.

- The vise is shipped with a protective coating. This coating should be removed before operation. Use penetrating oil to remove protective coating.
- Keep machined surfaces and all moving parts clean and free of dirt, chips and foreign materials.
- Keep machined surfaces and lead screws lubricated with medium weight machine oil.

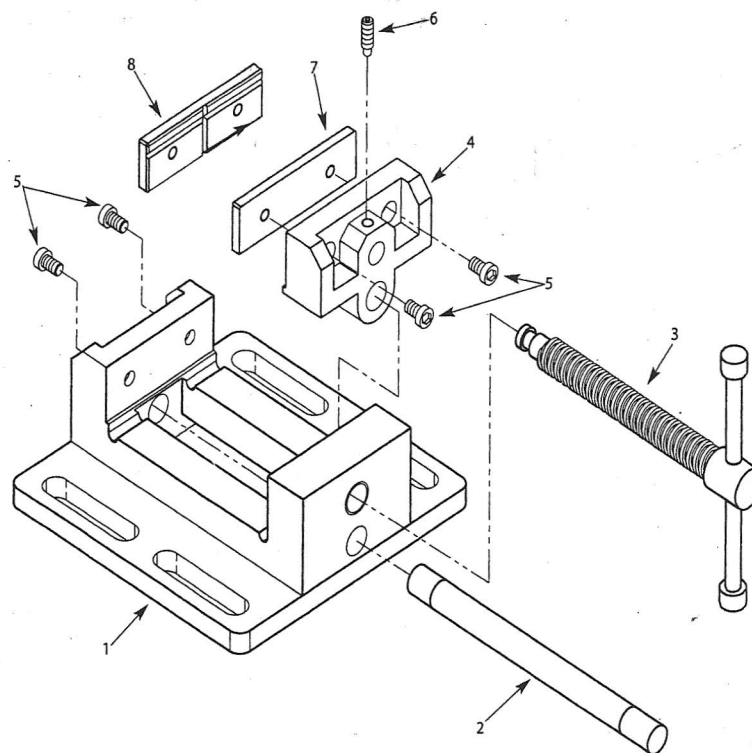

Figure 2 - Replacement Parts Illustration for 3", 4", 6" and 8" Low-Profile Drill Press Vises

REPLACEMENT PARTS LIST FOR LOW-PROFILE DRILL PRESS VISES

Ref. No.	Description	Part Number for:				Qty.
		3" 12303A	4" 12403A	6" 12601A	8" 12801A	
1	Base	†	†	†	†	1
2	Slide Bar	28530.00	28536.00	28542.00	28547.00	1
3	Lead Screw with Handle	28531.00	28537.00	28543.00	28548.00	1
4	Moving Jaw	28532.00	28538.00	28544.00	28549.00	1
5	6-1.0 x 12mm Socket Head Bolt	*	*	—	—	4
5	8-1.25 x 12mm Socket Head Bolt	—	—	*	—	4
5	8-1.25 x 25mm Socket Head Bolt	—	—	—	*	4
6	6-1.0 x 10mm Set Screw with Ball	28533.00	—	—	—	1
6	8-1.25 x 10mm Set Screw with Ball	—	28539.00	28539.00	28539.00	1
7	Flat Jaw Plate	28534.00	28540.00	28545.00	28550.00	1
8	Grooved Jaw Plate	28535.00	28541.00	28546.00	28551.00	1
Δ	Operator's Manual	28633.00	28633.00	28633.00	28633.00	1

Δ Not Shown.

* Standard hardware item available locally.

† Not available as replacement part.

WARRANTY

Palmgren warrants their products to be free of deficiency in material or workmanship. The duration of this warranty is expressly limited to one year parts and labor unless otherwise noted beginning from the date of delivery to the original user. The following Palmgren products carry the following warranties on parts with a 1 year warranty on labor:

- USA Machine vises – Lifetime
- Imported Machine vises – 2 years
- Bench vises – 2 years
- Positioning tables – 2 years
- Bench grinders & buffers – 3 years
- Tapping machines – 2 years
- Drilling machines – 2 years
- Finishing machines – 2 years
- Band saws – 2 years
- Work stands – 2 years

The obligation of Palmgren is limited solely to the repair or replacement, at our option, at its factory or authorized repair agent of any part that should prove deficient. The warranty does not cover expendable and/or wear parts (i.e. v-belts, coated abrasives), damage to tools arising from alteration, abuse or use other than their intended purpose, packing and freight. Purchaser must lubricate and maintain the product under normal operating conditions at all times. Proper use and care instructions are provided in the operator's manual. Failure to follow these instructions will void the warranty.

This warranty is the purchaser's exclusive remedy against Palmgren for any deficiency in its products. Under no circumstances is Palmgren liable for any direct, indirect, incidental, special or consequential damages including lost profits in any way related to the use or inability to use our products. This warranty gives you specific legal rights which may vary from state to state.

SERVICE & REPAIR

1. If a Palmgren product requires a repair or warranty service **DO NOT** return the product to the place of purchase.
2. All warranty related work must be evaluated and approved by Palmgren.
3. Prior to returning any item the user must obtain factory approval and a valid RGA number.
4. For instructions and RGA number call toll free (800) 621-6145.

PALMGREN